

Location MAP
(Map Not to Scale)

Site Address : **The Grand Anukampa**,
Plot No. S-01, Near Shyam Nagar, Ajmer Road, Jaipur

3d artistic impression

<ul style="list-style-type: none"> • Railway Station - 15 min. • Ram Nagar Metro Station - 2 min. • Vivek Vihar Metro Station - 5 min. • Bus Stand - 20 min. • Shopping Mall - 5 min. 	<ul style="list-style-type: none"> • Hospitals - 2 min. • Sodala Circle - 2 min. • Schools - 5 min. • Local Market - 2 min. • Police Station - 5 min. 	
---	---	--

Location Advantage :

RERA Registration Number : RAJ/P/2018/823
www.rera.rajasthan.gov.in

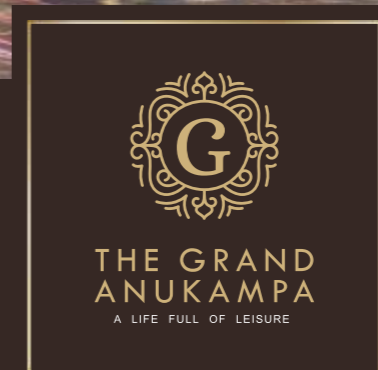

AN INTRODUCTION



Corporate & Marketing Office :
Anukampa Avas Vikas LLP.
7th Floor, Fortune Heights, Near Ahinsa Circle,
C-Scheme, Jaipur | T : +91 141 4212121 (21 Lines)

24x7 Call Assistance : 9214 000 000

E-Mail : sales@anukampagroup.com

Website : www.anukampagroup.com

Architects :



Graphite Design Studio
68, Janak Puri-Ist, Imliwala Phatak,
Opp. Jain Mandir, Jaipur-302005
T: 0141-2593414 M. +91 99283 34414.
@akshit@graphitedesignstudio.com

Graphite Design Studio (9928334414)

Disclaimer : Builders and Developers reserve the right to change any design and specification of the building without any prior notice and information. This brochure is for illustration purpose only and it cannot be in any way treated as a legal document. All information, specification, plans material and visual representations contained in the brochure, model & sample flat are subject to change from time to time by the developer and / or the competent authorities and shall not form part of the offer or contract.



● Grand Hotel Lobby



● Grand Entrance



● Indoor Games Room



● Food Court



● Gymnasium



● Hotel Meeting Room



● Restaurants



● Landscaped Terrace



● Roof-Top Swimming Pool

Exclusive
...designed to pamper
the epicure in you!

THE GRAND ANUKAMPA focuses on chic lifestyle and contemporary design. Blending beautifully crafted living with understated modern era, these **Boutique Apartments** are built and styled to stand the test of time.

Ultimate mixed use destination that will be the quintessential city center where shopping, entertainment, leisure, living and business merge seamlessly. This integrated development has been designed as a 360 degree lifestyle hub for the vibrant and dynamic community consisting of high street retail, with several fine dining restaurants, cafes, multi-cuisine food court, five star Hotel, Office suites and Boutique Apartments.

Here, meticulously planned details enhance the shopping experience with the combination of pedestrian-friendly pathways, convenient underground parking, glittering frontages, open landscaped areas, banquet lawn and buzzy sidewalk cafes & restaurants.

LUXURY LIVING IN
THE HEART OF THE CITY

Fully Furnished

Boutique Apartments

WORLD-CLASS CLUBHOUSE FACILITIES

- Roof-Top Swimming Pool • Ultra Modern Gymnasium
- Kid's Play Area • Roof-Top Cafeteria • Aerobics
- Yoga / Meditation Area • Kid's Zone
- Indoor Games Room

AN ULTIMATE MIXED USE DESTINATION

- Showrooms • Business Offices • Impressive Hotel Block Lobby
- Restaurants • Open to Sky Food Court • Banquet Lawn

Top-of-the-line Assortments

- Entrance Gate with 24hrs. Manned Security
- Dedicated Building Services Management
- 100% Power Backup for common area
- Earthquake Resistant Structure as per NBC
- Ample Open & Covered Car Parking
- High Speed Elevators
- Location advantage with connectivity from all parts of the city.



**THE GRAND
ANUKAMPA**
A LIFE FULL OF LEISURE



It's about unwinding, initiating *relaxation*, rejuvenation & holistic *well being*...



CLUBHOUSE FACILITY

ON 11th FLOOR

TERRACE FLOOR BLOCK LAYOUT

CLUBHOUSE FACILITY

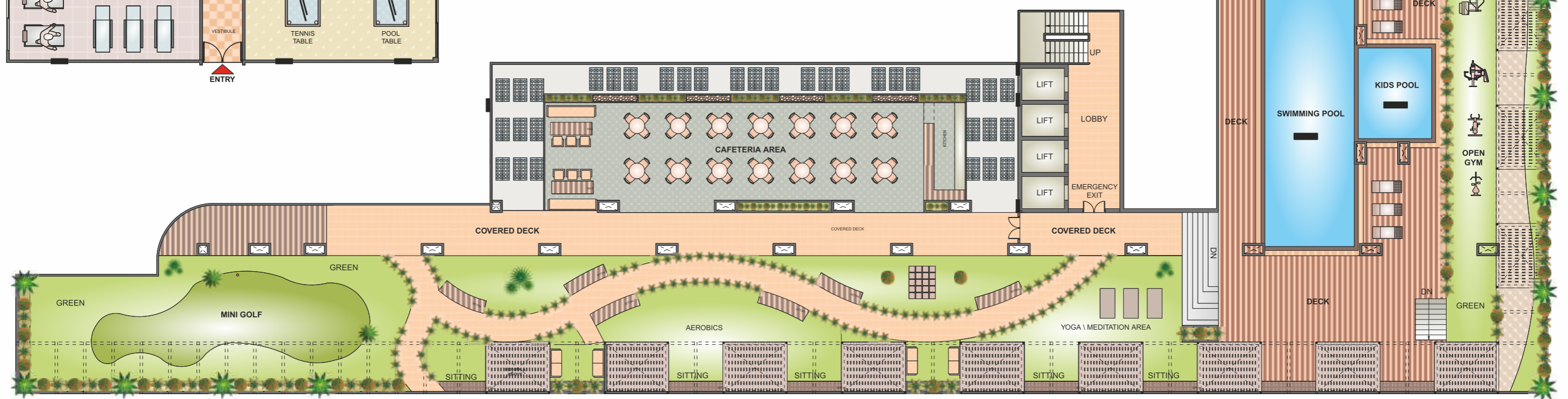

TYPICAL FLOOR BLOCK LAYOUT

FULLY FURNISHED BOUTIQUE APARTMENTS

4th to 10th Floor Typical Plan

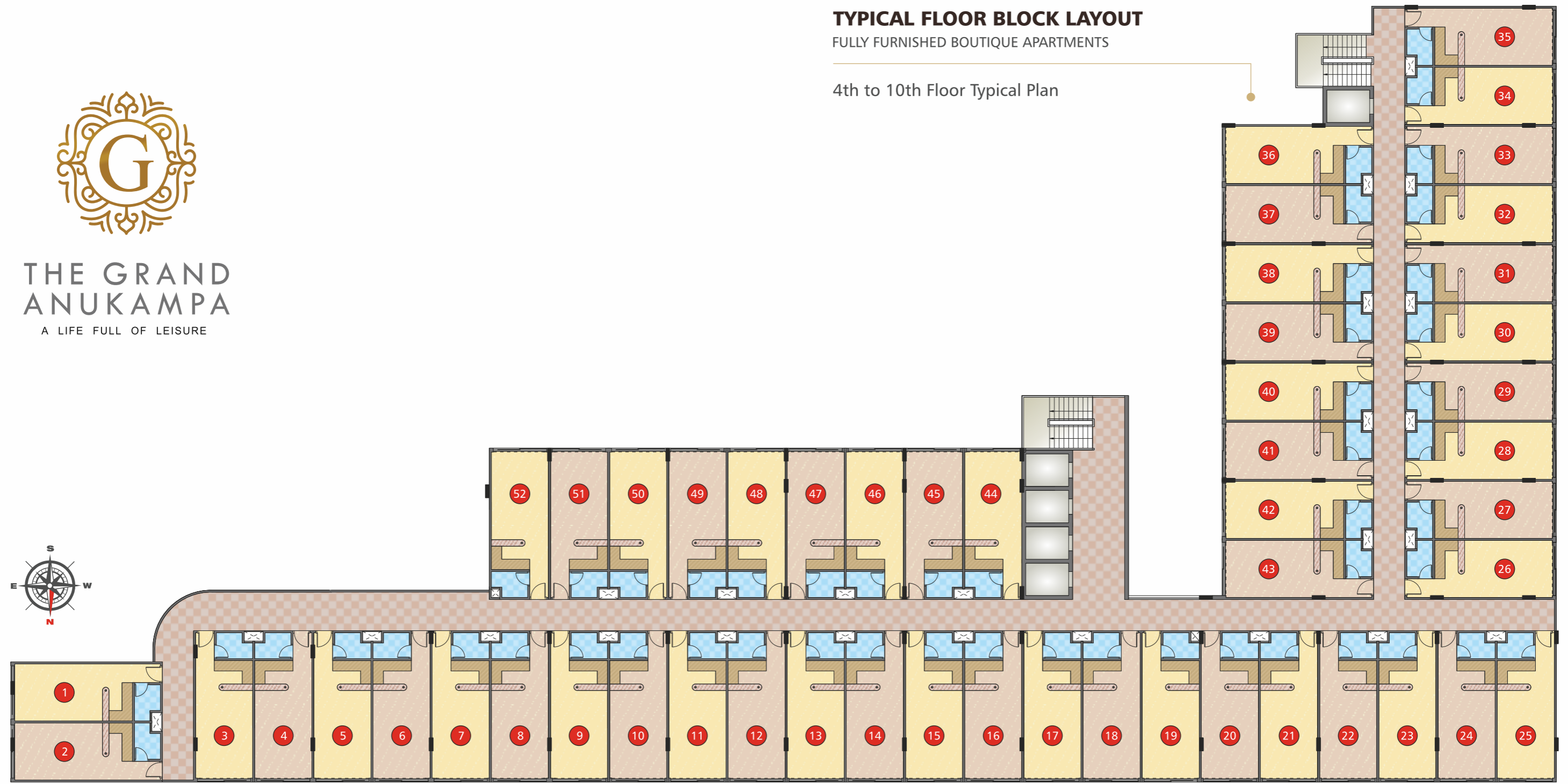

FULLY FURNISHED SERVICE APARTMENT

ISOMETRIC 2D & 3D VIEW

SALEABLE AREA = 492 SQ.FT.

CARPET AREA = 304 SQ.FT.

BUILT-UP AREA = 328 SQ.FT.

